



# Series 1500

## Meyer Insulation Blower

### Models 1502 & 1505A

#### INSTALLATION, OPERATION & MAINTENANCE INSTRUCTIONS



Wm. W. Meyer & Sons, Inc.

1700 Franklin Blvd. • Libertyville, Illinois 60048-4407 • 800-963-4458 • 847-918-0111 • Fax: 847-918-8183  
e-mail: [info@wmwmeyer.com](mailto:info@wmwmeyer.com) · websites: <http://www.meyercontractor.com> or [www.wmwmeyer.com](http://www.wmwmeyer.com)

## TABLE OF CONTENTS

|  |    |
|--|----|
| Safety Precautions .....                                   | 2  |
| Applications - Intended Use of Equipment .....             | 7  |
| Receiving and Uncrating .....                              | 8  |
| Specifications - Power Take Off Machine - Model 1502 ..... | 8  |
| Specifications - Engine Driven Machine - Model 1505A.....  | 11 |
| Operating Instructions.....                                | 13 |
| Maintenance.....   | 16 |
| Troubleshooting.....                                       | 17 |



### SECTION I SAFETY PRECAUTIONS

#### **WARNING** TO THE OWNER, AND INSTALLATION, OPERATION AND MAINTENANCE PERSONNEL

The safety of the operator and those people that may come into contact with the equipment is of great importance to Wm. W. Meyer & Sons, Inc. “Meyer”. The decals, shields, guards and other protective features designed, furnished or recommended for this machine are there for your protection.

BEFORE attempting to install, operate or perform maintenance on this Equipment READ carefully and UNDERSTAND all safety instructions contained in this set of **Instructions** in addition to all applicable government safety/health laws and regulations and generally recognized industry standards. The operation and maintenance of this equipment should be restricted to only those personnel trained in its use. Consult Factory for the availability of manuals in other languages.

Installation, Operation and Maintenance personnel should READ carefully and UNDERSTAND the sections of this **Instruction Manual** relevant to the work they are performing. The various precautions and recommendations detailed within this manual are not necessarily all inclusive. These instructions are intended to provide general safety and operational guidance relating to typical uses with which Meyer is familiar. Additional information may be provided that pertains to your specific piece of equipment upon request.

#### **SAFETY FIRST!**

 **DANGER** Indicates the presence of a hazardous situation that, if not avoided, WILL result in death or serious injury.

 **WARNING** Indicates the presence of a hazardous situation that, if not avoided, COULD result in death or serious injury.

 **CAUTION** Indicates the presence of a hazardous situation that, if not avoided, COULD result in minor or moderate injury.

 **NOTICE** Indicates information that is important, but is not related to a particular hazard.

 **SAFETY INSTRUCTIONS** Indicates specific safety related instructions or procedures.



**WARNING** To avoid serious injury or death, follow the safety information in the following sections.

### 1-1 GENERAL SAFETY INFORMATION

- Equipment is to be operated by trained qualified personnel only.
- Always read and follow the operating and safety procedures.
- Do not operate without all guards and safety equipment installed in the proper location and in working order.
- Do not disable any safety features. They are there for your protection.
- Always use qualified personnel when repairing or maintaining the equipment.
- Do not leave the equipment unattended while it is running.
- Do not wear loose clothing or jewelry when operating this equipment. Long hair should be confined by a hat or a hair net.
- Do not operate under the influence of alcohol or drugs.
- If a malfunction should occur, turn the machine off immediately and correct the problem, before restarting the machine.

#### Emergency Shut Down Procedure

Push the E-Stop Button in. This will stop the machine completely. Before continuing operation, you must determine the reason for the E-Stop. Turn the engine ignition key to the OFF position and remove the key. Follow your employer's Lockout/Tag out procedures. After the issue has been identified and corrected the machine may be put back into operation.

### 1-2 INSULATION MACHINE SAFETY

- Limit the operation only to those personnel trained in the proper use and operation of the machinery.
- Never operate the machine without proper ventilation.
- Keep all clothing and your body away from the rotating equipment.
- Keep the blowing hose in good repair.
- Never use anything to push material in the hopper. The hopper has been designed to move the material in the proper fashion and speed to the front of the hopper.
- Never operate the machine without the blower inlet screen in place.
- Do not change the fuse ratings or bypass the fuses.
- Obey all safety labels and instructions affixed to the machine. Do not point discharge hose at anything other than empty space, do not place hand(s) or any objects in material discharge stream.
- Never run the machine speed faster than the factory settings.
- Always wear proper personal protective equipment including but not limited to eye protection, hearing protection, respirator and gloves.
- Do not smoke while operating the machinery.
- Prior to performing any service or maintenance follow MACHINE SAFETY SHUTDOWN INSTRUCTIONS.

### 1-3 HYDRAULIC SYSTEM SAFETY

The hydraulic system for this machine is designed to provide an alternative to multiple chain and belt drives. As with any system, safety precautions and proper maintenance procedures must be followed. The hydraulic system is capable of developing pressures in excess of 1,000 psi and fluid temperature above 160°F, therefore before performing any service or maintenance, shut down the machine according to the Machine Safety Shutdown Instructions. Only those trained in hydraulic system service or maintenance should be involved with the replacement of hoses, couplings or other parts

of the system. Read and understand the Material Safety Data Sheet on the hydraulic fluid used in this machine.

- Never operate this equipment if there is any fluid leaking from the hoses, connections, pumps or motors.
- Never inspect the machine while it is in operation.
- Wear safety glasses and mask when working with the fluid.
- Avoid contact with skin. Wear long sleeves and rubber gloves. Wash contaminated skin immediately.
- Hydraulic fluid is flammable and must be kept away from heat and ignition sources.
- If any injection, ingestion or inhalation of hydraulic fluid should occur, seek medical attention immediately. Do not delay no matter if the exposure appears minor. Hydraulic fluid can cause serious injury or death.

If there are any questions as to the safe operation of this equipment, please do not hesitate to contact us at 1-800-963-4458.

#### 1-4 SAFETY LABELING

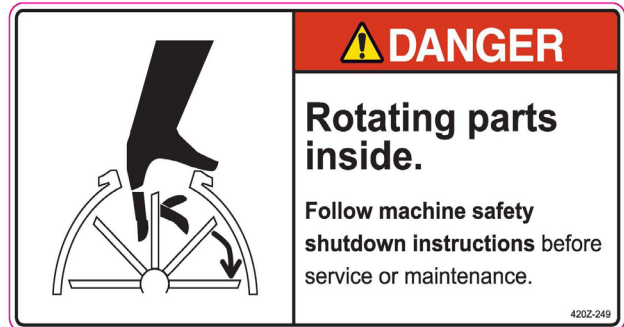



Model 1505A

## MACHINE SAFETY SHUTDOWN INSTRUCTIONS

Before reaching into the machine or performing any service or maintenance, the following steps must be taken to ensure that the machine cannot be started or operated.

1. Follow the Machine Shutdown Instructions.
2. Disconnect the fuel tank and close the vent on the tank.
3. Disconnect the negative battery terminal and secure it.
4. Follow your employer's Lockout/Tagout procedures.

420Z-256

Model 1502

## MACHINE SAFETY SHUTDOWN INSTRUCTIONS

Before reaching into the machine or performing any service or maintenance, the following steps must be taken to ensure that the machine cannot be started or operated.

1. Follow the Machine Shutdown Instructions.
2. Disconnect the negative battery terminal and secure it.
3. Follow your employer's Lockout/Tagout procedures.

420Z-305



### WARNING

**To reduce the risk of serious injury or death:**

Equipment must be operated, serviced and maintained by trained personnel.

Read and understand all instructions before operating, servicing or maintaining this machine.

### WARNING



**Hearing protection required**



**Eye protection required**



**Breathing protection required**



**Protective clothing required**

420Z-204



### WARNING

Hydraulic fluid is flammable. Keep away from heat and ignition sources.

Clean up any spills using only non-sparking tools and explosion proof equipment. Collect spills on absorbent material and put into an approved container.

420Z-301



### WARNING

Hydraulic fluid under pressure can cause skin injection injury.

If you suspect an injury, no matter how minor it may seem, get medical attention immediately. Failure to do so can lead to gangrene and loss of limb.

Follow Machine Safety Shutdown Instructions before any inspections, service or maintenance is performed.

420Z-302



# WARNING



**Machine is operated by remote control and can start at any time.  
Moving parts can crush and cut.**

**Follow Machine Safety Shutdown Instructions** (near control panel) before removing guards, servicing, or performing maintenance or when reaching into any work zone to make adjustments, clear product and supplies, clean the equipment, or investigate a malfunction.



**Follow all safety instructions** to reduce the risk of serious injury or death from electrical shock, moving parts, thrown objects, or other hazards.



**Intended use and use environment**

This machine is suitable for Loose Fill insulation only. Any other use could cause serious injury, costly damage to the equipment and will void the warranty.

Operate only in well ventilated areas. Failure to do so could result in death due to carbon monoxide poisoning.

Questions regarding safety, operation, and application suitability should be directed to Wm. W. Meyer and Sons, Inc.



**Qualifications and responsibilities**

Always refer to applicable safety standards and local requirements when using this equipment.

**Owner responsibilities:**

- Provide operation and maintenance personnel with the Installation, Operation, and Maintenance Instructions (additional copies available from Wm. W. Meyer and Sons, Inc.)
- Make sure personnel are properly trained on equipment use and safety.

**Operation and Maintenance Personnel responsibilities:**

- Be properly qualified to operate or service the equipment:
  - Read and follow all instructions on the equipment labels and in the Installation, Operation, and Maintenance Instructions, including appropriate supporting vendor information.
  - Never operate or maintain this equipment under the influence of alcohol or drugs or conditions which reduce alertness or judgment.
- Always wear proper hearing, eye and breathing protection along with protective clothing.



**Operating location**

- An operator must always be close enough to the machine to promptly turn it off in case of emergency.
- Never blow insulation on or near sources of heat, flame, sparks or static discharge.



**Keep yourself and others clear of machine and discharge**

- Never operate the machine without all guards properly installed.
- Keep hands, feet, hair, loose clothing, jewelry and any foreign objects away from moving parts during operation.
- Never allow untrained personnel in the area near the equipment or the air/material discharge location.
- Never direct discharged materials at bystanders or put hands or objects in the discharge stream.



DO NOT REMOVE or disfigure this or any other instruction/safety label.

1700 Franklin Blvd • Libertyville, Illinois 60048-4407 • 800-797-8227 • 847-918-0111 • Fax: 847-918-8183  
e-mail: [info@wmwmeyer.com](mailto:info@wmwmeyer.com) • websites: <http://www.meyercontractor.com> or [www.wmwmeyer.com](http://www.wmwmeyer.com)

420Z-262



**! WARNING**

**Moving parts can crush and cut.**  
Never operate with guard removed.  
**Follow machine safety shutdown instructions** before service or maintenance.

420Z-253



**! WARNING**

**Open all doors on the truck body/trailer and wait 10 minutes before starting engine.**  
This ventilates fuel vapors and reduces the risk of fire and explosions.  
**DO NOT** start engine if fuel vapors are present.

420Z-258



**! WARNING**

**Unprotected material discharge can cause injury.**  
Always use hose when discharging material.  
Never direct discharged materials at bystanders or put hands or objects in the discharge stream.

420Z-217



**! WARNING**

**Do not reach into hopper.**  
Moving parts can crush and cut.  
**Follow machine safety shutdown instructions** before service or maintenance.

420Z-260

**HYDRAULIC SYSTEM INSPECTION INSTRUCTIONS**

With the truck securely parked and the machine unable to start, inspect the hydraulic system both on the machine and underneath the truck for:

- Leaks
- Loose connections
- Damaged/Worn parts

Replace any damaged or worn parts immediately. Do not operate the machine until after necessary repairs have been made.

If there are any questions about inspecting the hydraulic system, please do not hesitate to contact us at 1-800-963-4458

420Z-300



**SECTION II  
APPLICATION - INTENDED USE OF EQUIPMENT**

The **MEYER Series 1500 INSULATION BLOWING MACHINE** is designed to process and blow all of the currently available loose fill fiberglass and cellulose insulations on the market today.

**NOTICE**

This equipment must be used only for the purpose for which it was intended. Any other use could cause costly damage to the equipment and void the warranty.

Model 1502 - Hydraulic Power Take Off (PTO)

Model 1505A - Gas, Water Cooled Aegis Engine



### SECTION III RECEIVING AND UNCRATING

#### 3-1 RECEIVING YOUR MACHINE

Immediately check the condition of your new machine as received. The unit was shipped in perfect condition and should arrive the same way. Ownership of the goods was transferred to the carrier as soon as it left our dock. Your order may have shipped on multiple skids, verify your count equals that of the Bill Of Lading. If there are any missing items or visible problems, mark them on the Bill Of Lading that the carrier has and call their office immediately before the driver leaves your premises. Meyer cannot file a claim on your behalf; however, please let us know by phone and writing about any problems so that we can assist you with immediate replacement parts or information.

#### 3-2 UNCRATING YOUR MACHINE

1. Carefully remove all shipping materials from the machine.
2. Check that all parts are included as stated on the Packing List that came with your shipment.
3. If anything is missing for any reason, please contact Wm. W. Meyer & Sons immediately.
4. If the equipment or goods are discovered to be damaged in a shipment at a later date, contact the carrier and Wm. W. Meyer & Sons immediately.



### SECTION IV SPECIFICATIONS - POWER TAKE OFF MACHINE MODEL 1502

#### EQUIPMENT SPECIFICATIONS

WIDTH: 86" (218cm)  
DEPTH: 49" (125cm)  
HEIGHT: 72" (183cm)  
WEIGHT: APPROX. 1,950 LBS. (884 kgs.)

#### TEMPERATURE AND HUMIDITY LIMITS

Operating Temperature: -25°C to +25°C  
Transportation Temperature: 0°C to 40°C  
Humidity Limits: Rated up to 95%

#### MACHINE COMPONENTS

- Feeder Assembly
- Hopper Assembly
- Control Panel/Electrical



**WARNING** Two operators needed for safe operation.

- One hose operator
- One machine operator/loader



## Machine Installation

The truck that the machine is to be mounted in should have a minimum body length of 22' with a minimum GVWR of 21,000 lbs., double side door and a full width rear door.

Tools and material needed for installation:

- Drill and drill bits
- 3/8" bolts or lag screws
- Forklift or other safe means to lift the machine
- Pry bar(s)
- Screwdriver, socket and ratchet, saw (hole or saber)

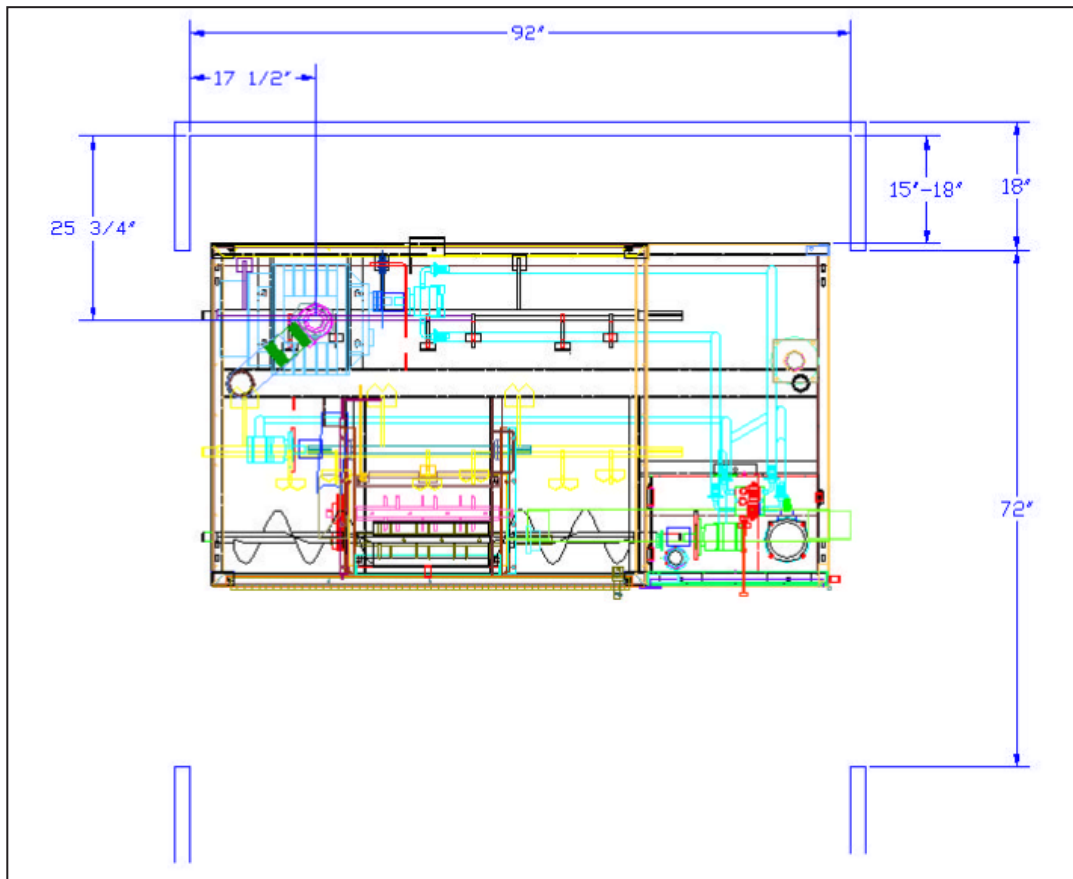

1. Move the machine into position noting that you will need to have access to the rear of the machine. With the machine in position; mark the truck floor where the base mounting holes will be located and where the blower inlet pipe will go through the floor.
2. The machine can be left in place or moved to provide better access to the areas that need to be drilled/cut. Using a 1/8" bit, drill pilot holes to determine if there is anything under the truck floor that would interfere with the mounting fasteners or the blower inlet pipe. If there is; move the holes accordingly.
3. Cut a 3 1/2" hole for the blower inlet pipe. Install the rubber flashing for blower centering it over the hole.

4. A 6" diameter hole in the floor is needed for the hydraulic hoses coming from the pumps underneath the truck. There is some leeway as to the exact hole location. The hole should be inside the machine base near the hydraulic tank. When installed, the hoses must not come in contact with any moving parts, above or below the floor, and must have smooth radius bends.
5. Drill holes for the machine mounting bolts. The size depends on what type and size of fasteners you are using. Secure the machine to the truck floor.
6. Push the blower inlet pipe with screen up through the flashing and thread it into the blower.



Position the truck exhaust outlet away from the blower inlet. This is to prevent exhaust fumes from being sucked into the blower and pumped into the attic. This would be a life threatening situation for both the installer and the building occupants.

### **Model 1502 - Power Take Off (PTO) Installation**

Installation of a PTO should only be performed by a qualified installer or by Meyer & Sons. Read and understand the PTO manufacturer's Installation and Operation manual. If you have purchased the hydraulic PTO installation parts with your machine, you should have everything needed for installation.

Note: Some connectors and hoses may have to be substituted based on your unique installation requirements.

The Meyer 1502 machine is hydraulically powered by an external dual hydraulic pump coupled to a power take-off (PTO). The pump and PTO are not included with the machine and must be ordered separately. The PTO is attached to the truck's transmission. The balance of the hydraulic system is integral to the machine. The installation is not trivial and should be performed by individuals experienced with PTO's and hydraulics. The PTO must be selected to match the particular dual pump and truck transmission. Pumps are available in both clockwise and counterclockwise rotations to accommodate the various PTO's and transmissions. Four hoses connect the pumps to the machine; two are supply hoses that route fluid from the hydraulic tank on the machine to the inlets of the pumps, two are pressure side hoses that route fluid from the pumps to the machine. The pump nearest the PTO (inboard pump) is the higher flow blower pump and its hose connects to P1 on the hydraulic block. The outboard pump hose connects to P2. The hoses must be run and supported in such a manner as to prevent them from rubbing and abrading against parts of the machine and truck.



Worn hoses pose a potential hazard and must be replaced immediately. Even if the hose is not currently leaking when the machine is operating the hose is subject to high pressure and could fail without warning. Failure to do so, could lead to serious injury or death.

This completes the mechanical installation for the Meyer 1502.

Your Meyer 1502 was checked and thoroughly run before it was shipped, but it is always a good idea to check; all set screws, all hoses for leakage and all fluid levels.

### **Electrical Installation**

The Meyer 1502 is powered electrically by the truck battery and charging system. Two cables of two wires each are provided that terminate to the truck electrical system. One cable is power for the machine and terminates at the truck battery. The other cable is connected to the PTO electrical system.

The power cable includes wires which are marked #3 and #8. #3 is a black wire (POSITIVE) marked with red tape and #8 is a white wire (NEGATIVE) marked with black tape. The red and black tape represent (+) and (-) respectively - the convention for extra-low voltage DC wiring. An in-line 30 amp slow blow fuse rated at 30 VDC should be wired between the #3 wire and the battery. Wire #8 should terminate at the negative terminal of the battery or to the frame of the vehicle.

The other cable includes wires marked #9 and #10. Terminate wire #9 to the line side of the PTO "On" indicator light in the dash. Terminate wire #10 to the load (ground) side of the light.



## SECTION V SPECIFICATIONS - ENGINE DRIVEN MACHINES MODEL 1505A

### EQUIPMENT SPECIFICATION TEMPERATURE AND HUMIDITY LIMITS

|         |                               |                             |                 |
|---------|-------------------------------|-----------------------------|-----------------|
| WIDTH:  | 86" (218cm)                   | Operating Temperature:      | -25°C to +25°C  |
| DEPTH:  | 49" (125cm)                   | Transportation Temperature: | 0°C to 40°C     |
| HEIGHT: | 72" (183cm)                   | Humidity Limits:            | Rated up to 95% |
| WEIGHT: | APPROX. 1,950 LBS. (884 kgs.) |                             |                 |

### MACHINE COMPONENTS

- Feeder Assembly
- Hopper Assembly
- Control Panel/Electrical
- Engine
- Dual Clutch Drivetrain

**⚠ WARNING** Two operators needed for safe operation.

- One hose operator
- One machine operator/loader

### Machine Installation (Engine Driven)

The truck that the machine is to be mounted in should have a minimum body length of 22' with a minimum GVWR of 21,000 lbs., double side door and a full width rear door.

Tools and material needed for installation:

- Drill and drill bits
- 3/8" bolts or lag screws
- Exhaust pipe fittings from the machine to underneath the truck (2 ½")
- Forklift or other safe means to lift the machine
- Pry bar(s)
- Screwdriver, socket and ratchet, saw (hole or saber)

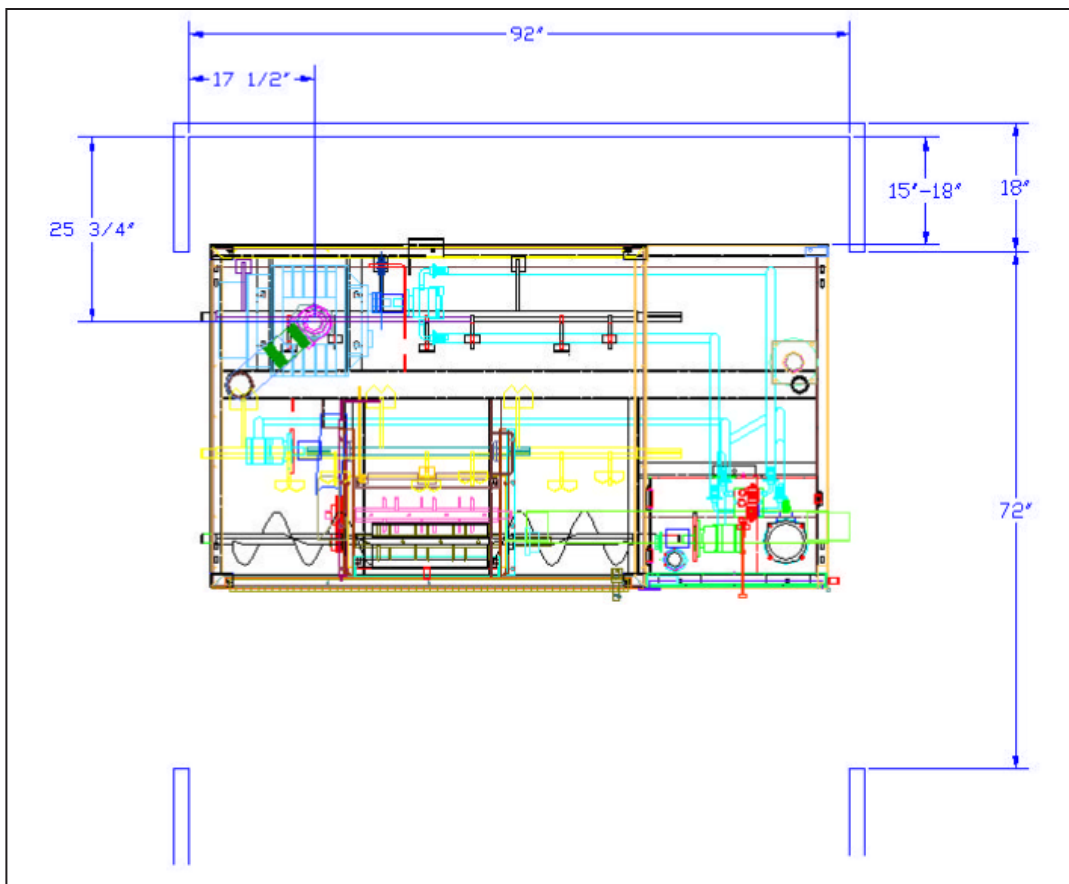

1. Move the machine into position noting that you will need to have access to the rear of the machine. With the machine in position; mark the truck floor where the engine exhaust will go through the floor and mark the base's mounting hole locations. Mark the truck floor where the blower inlet pipe will go through.
2. The machine can be left in place or moved to provide better access to the areas that need to be drilled/cut. Using a 1/8" bit, drill pilot holes to determine if there is anything under the truck floor that would interfere with the mounting fasteners, the engine exhaust pipe or the blower inlet pipe. If there is; move the holes accordingly.
3. Cut a 3" hole in the floor for the exhaust pipe and a 3 1/2" hole for the blower inlet pipe. Install the flashing for both (included-steel for exhaust, rubber for blower), center it in the hole and tack it down.
4. Drill holes for the machine mounting bolts. The size depends on what type and size of fasteners you are using. Secure the machine to the truck floor.

**⚠️ WARNING** The engine and engine exhaust piping could be extremely hot and could cause burns. In addition; if flammable material comes in contact with these surfaces it could ignite. Due to the variability of installations, Meyer cannot provide a guard for the engine exhaust piping. The installer of the equipment must take the necessary steps to guard this surface from contact.

**⚠️ WARNING** Position the truck exhaust and engine exhaust outlet away from the blower inlet. This is to prevent exhaust fumes from being sucked into the blower and pumped into the attic. This would be a life threatening situation for both the installer and the building occupants.



5. Install the exhaust pipe and fittings (not included). Be sure to securely attach both ends of the exhaust extension. Thread in the blower inlet pipe and screen (included) up through the rubber flashing.



## SECTION VI OPERATING INSTRUCTIONS

### POWER TAKE OFF MODEL 1502

**⚠️ WARNING** Before starting the machine; check that no foreign material is in the hopper, that the blowing hose is connected and the hose operator is in position. Ensure that the only people around the machine are those involved with its operation.

#### PRE-START CHECKS

1. Inspect all hydraulic parts and connections before starting the machine. Look for any dripping or pooling of hydraulic fluid. Do Not start the machine if present.
2. Inspect all hydraulic hoses on the machine for wear; especially those that come from the pumps under the truck and through the floor.
3. Check the hydraulic fluid level before operation.
4. The blowing hose must be attached and the operator in position.
5. Connect the cord to the control panel.

**⚠️ WARNING** Do not operate the machine with any guards removed. The drive components must be guarded before starting your machine and must remain guarded during operation. Failure to do so could lead to serious injury or death.

#### MACHINE START UP INSTRUCTIONS

Read and understand this Installation, Operation and Maintenance manual and the Power Take Off Operator's manual before operating this equipment. NOTE: Failure to follow proper shifting or operating sequences will result in premature PTO failure with possible damage to other equipment.

1. Turn the Remote ON/OFF selector switch counterclockwise. (Off Position)
2. E-Stop button should be released. (Turn CW to release)
3. Engage the Power Take Off (PTO) with the truck engine at idle speed. The Power light and PTO Engaged light on the machine panel will come on.

NOTE: The engine must be at idle when the PTO is initially engaged.

4. Increase the engine speed until the machine tachometer reads 1100 RPM. Set the engine speed according to the Operator's manual for the PTO.
5. Close the slide gate.

6. Switch on the Remote by turning the ON/OFF Selector Switch clockwise. (On Position) The Remote Control is now energized and can be used to control the machine.
7. Open the slide gate and set it based on your blowing material. Turn the slide gate selector switch CCW to open (green light illuminates) and CW to close (white light illuminates).

### **MACHINE SHUTDOWN INSTRUCTIONS**

1. Close the slide gate. (Turn selector switch CW)
2. Handheld remote:  
Press the Stop button, press the Air button to clear the Hose, and then press the Stop button again to stop the machine.
3. Control Panel:  
Turn the Remote ON/OFF switch CCW to OFF and disconnect the cord.
4. Reduce engine speed to idle and disengage the PTO per the manual.
5. Turn the engine ignition key to the OFF position and remove the key.

### **MACHINE SAFETY SHUTDOWN INSTRUCTIONS**

1. Follow the MACHINE SHUTDOWN INSTRUCTIONS.
2. Disconnect the negative battery terminal and secure it.
3. Follow your employer's Lockout/Tag out procedures.

## **NOTICE**

Disengage the PTO before driving the truck. Failure to do so will cause severe damage to the insulation machine and PTO components

### **ENGINE DRIVEN MODEL 1505A**



## **WARNING**

Before starting the machine; check that no foreign material is in the hopper, that the blowing hose is connected and the hose operator is in position. Ensure that the only people around the machine are those involved with its operation.



## **WARNING**

**POISONOUS GAS HAZARD.** Engine exhaust contains carbon monoxide, a poisonous gas that could kill you in minutes. You CANNOT see it, smell it, or taste it. Even if you do not smell exhaust fumes, you could still be exposed to carbon monoxide gas. If you start to feel sick, dizzy, or weak while using this product, shut it off and get to fresh air immediately. Seek medical attention immediately. You may have carbon monoxide poisoning.

### **PRE-START CHECKS**

1. The doors to the truck/trailer must be open so that the operator and machine have adequate ventilation.
2. If there is a fuel odor, wait 10 minutes to allow the fuel vapor to dissipate before proceeding.
3. The blowing hose must be attached and the operator in position.
4. Check that the switch on the Remote Control Cord is in the OFF position. Connect the cord to the control panel. Note: Starting the machine with the switch set to AIR or AIR/MATERIAL will overload the clutch and the engine.



**WARNING** Do not overfill the fuel tank. Allow room for expansion of the fuel. Fill the tank away from the engine and avoid spills. The fuel tank must be in contact with the ground before and during filling. Keep the fuel nozzle in contact with the fill opening at all times. Do not let the fuel line come in contact with the exhaust system. Fuel for this machine is highly flammable; failure to follow these precautions could lead to a fire and serious injury or death.



**WARNING** Do not operate the machine with any guards removed. The drive components must be guarded before starting your machine and must remain guarded during operation. Failure to do so could lead to serious injury or death.

### **MACHINE START UP INSTRUCTIONS**

Read and understand the Operation and Maintenance manual before starting machine.

1. Doors to the truck/trailer must be open and no fuel vapor present.
2. Turn the Remote On/Off selector switch counterclockwise. (Off Position)
3. E-Stop button should be released. (Turn CW to release)
4. Attach the fuel line and open the vent on the fuel tank.
5. Turn the engine ignition key to On, this will energize the panel.
6. Close the slide gate.
7. The Green Power light will illuminate. The Red Low Oil Pressure light will turn on and the Red High Temperature light should be off.
8. Depress and hold the Green Start Button, turn the Key Switch CW to the start position. The engine will start. Continue to hold the Green Start Button until the Red Low Oil Pressure light goes out. When the Green Start Button is released it should remain lit.
9. Run the engine at half speed until the engine warms up, approximately 5 minutes. Then set the engine speed using the throttle. Tachometer should read 1100 Rpm.
10. Switch on the Remote by turning the On/Off Selector Switch clockwise. (On Position) The Remote Control is now energized and can be used to control the machine.
11. Open the slide gate and set it based on your blowing material. Turn the slide gate selector switch CCW to open (green light illuminates) and CW to close (white light illuminates).

### **MACHINE SHUTDOWN INSTRUCTIONS**

1. Close the slide gate. (Turn selector switch CW)
2. Handheld remote:  
Press the Stop button, press the Air button to clear the Hose, and then press the Stop button again to stop the machine.
3. Control Panel:  
Turn the Remote ON/OFF switch CCW to OFF and disconnect the cord.
4. Push the throttle all the way in. Let the engine idle for a couple of minutes to cool down.
5. Turn the ignition key to the OFF position and remove the key.

## MACHINE SAFETY SHUTDOWN INSTRUCTIONS

1. Follow the MACHINE SHUTDOWN INSTRUCTIONS.
2. Disconnect the fuel tank and close the vent on the tank.
3. Disconnect the negative battery terminal and secure it.
4. Follow your employer's Lockout/Tag out procedures.

NOTE: Whenever the machine is not in use or is being transported, disconnect the fuel line and close the vent on the fuel tank. Secure the tank before transporting the machine.



## SECTION VII MAINTENANCE

**! WARNING** Before performing any maintenance or service ensure that the machine cannot be started. Failure to do so could lead to serious injury or death. Follow Machine Safety Shutdown Instructions.

|                 |   |
|-----------------|---|
| ALL BEARINGS    | NLGI grade #2 LITHIUM GREASE              |
| DRIVE CHAIN     | 30W NON DETERGENT MOTOR OIL               |
| BLOWER          | OIL: AEON<br>NLGI grade #2 LITHIUM GREASE |
| HYDRAULIC FLUID | ISO VISCOSITY GRADE: 32                   |

Your Meyer Series 1500 Insulation Blower is designed to be used with minimal maintenance for all its components. The following is a minimum recommended maintenance schedule.

| DESCRIPTION                  | EACH SHIFT | 20 HRS | 100 HRS | 250 HRS | 500 HRS |
|------------------------------|------------|--------|---------|---------|---------|
| INSPECT ALL DRIVES           | X          |        |         |         |         |
| CHECK GUARDS                 | X          |        |         |         |         |
| HYDRAULIC HOSE & CONNECTIONS | X          |        |         |         |         |
| GREASE BLOWER BEARINGS       |            |        |         |         | X       |
| GREASE HOPPER BEARINGS       |            |        |         |         | X       |
| CHANGE BLOWER OIL            |            |        |         |         | X       |
| CHANGE GEAR BOX OIL          |            |        |         |         | X       |
| CLEAN INLET SCREEN (BLOWER)  | X          |        |         |         |         |
| CHANGE SEAL STRIPS           |            |        |         |         | X       |
| OIL DRIVE CHAINS             |            |        |         |         | X       |
| CHECK ALL DRIVE SET SCREWS   |            |        |         |         | X       |
| CHECK/CLEAN HEAT EXCH FILTER | X          |        |         |         |         |
| CHECK HYDRAULIC FLUID LEVEL  | X          |        |         |         |         |
| CHANGE HYRDAULIC FLUID       |            |        |         |         | X       |
| CHANGE ENGINE OIL/FILTER     |            |        | X       |         |         |
| ENGINE AIR FILTER            | X          |        |         |         |         |
| CLEAN INLET FILTER (ENGINE)  | X          |        |         |         |         |
| CHECK ENGINE EXHAUST PIPE    | X          |        |         |         |         |





**WARNING** Removing guards exposes personnel to moving parts. Prior to removing any guards, the machine must be prevented from starting and the parts from moving. Remove the key from the engine ignition/truck ignition (PTO), disconnect the fuel line, and disconnect the negative battery terminal and secure it. Follow your employer's Lockout/Tag out procedures.

In order to perform any service or maintenance on the machine, the guards must be removed.

1. Follow MACHINE SAFETY SHUTDOWN INSTRUCTIONS.
2. Remove the guards as necessary to work on the machine.
3. Replace the guards after completing the service or maintenance and before operation.

It is imperative when replacing or tightening chain that the sprockets are in line with each other. Use a straight edge of sufficient length to make the determination.

Check the tension on the chain drives when they are lubricated. On the hopper chain drives, if there is more than 3/4" deflection or play measured equidistant between the sprockets, the chain needs to be replaced.



## SECTION VIII TROUBLESHOOTING

If the machine is not running properly check for the simple causes first; closed slide gate, broken chain, machine speed, etc.

### **Machine is running but no material is discharging from hose.**

- Slide gate is in the closed position.
- Feeder shear pin is broken.
- Remote Control wire or panel connector is broken or damaged.
- Remote Control wire board connections loose.
- Faulty clutch relay on circuit board or faulty circuit board.
- Drive belt is slipping or broken.
- Feeder chain is off the sprocket or broken.
- Hopper chains are off their sprockets or broken.
- Material jam in machine or hose.
- Hose is bent or closed off from machine to attic.
- Worn out seals in feeder causing air pressure blowback.

### **Low material output.**

- Check slide gate position.
- Partial obstruction in hopper or hose.
- Hose is kinked or torn.
- Machine speed is too low.

- Blower inlet is clogged.
- Blower outlet tubing to feeder has slipped off its connection.
- Bleed valve assembly is in the open position.
- Operator is overfilling hopper resulting in material top pressure which can lead to material bridging above the feed reel.
- Material is sticking to agitator or feed reel from forcing too much material into the hopper, this practice causes less material to be conveyed through the system due to build up on surfaces.

**Machine seems sluggish while blowing material.**

- Material is wet inside hopper.
- Too much material forced into hopper.
- Too many hose reductions.
- Obstruction at blower inlet
- Drive belts may be slipping.
- Gear Box oil is low or empty.
- Loose drive components.

**Unusual sounds coming from machine during operation.**

- Banging sound from hopper area – Loose object has fallen into hopper.
- Constant air leaking sound while machine is in operation – Bleed valve is open or loose tubing between the blower and feeder.



# SAFETY SUPPLEMENT

Effective 4-20-2017

## ATTENTION INSTALLERS/OPERATORS FOR YOUR PROTECTION:

1. Read and understand the Operating Manual accompanying this equipment before performing any work.
2. Additional safety label kits are available from Meyer upon request at no charge. This is part of our effort to ensure this equipment is installed, operated and maintained in the safest possible manner. Affix these labels in locations to achieve maximum visibility and thereby alert any personnel that may ever be on-site that a potential for injury could occur.
3. Under no circumstances should this equipment be installed or operated in a manner that permits access to the interior of the insulation blowing machine.
4. Outlet connections must always have a hose attached.
5. ***Always follow machine safety shutdown instructions*** before performing any work.
6. Always keep loose clothing, hands, feet or any parts of your body, tools and/or any foreign objects away from the interior of hopper and hose.
7. Never remove the discharge hose that is attached to the machine without first powering OFF the machine.
8. Consult the Meyer factory if you have any questions regarding the proper installation, operation and maintenance of this equipment.

Wm. W. Meyer & Sons, Inc.

1700 Franklin Blvd • Libertyville, IL 60048 • Phones: 800-963-4458 or 847-918-0111 • Fax: 847-918-8183

Website: <http://www.meyercontractor.com> or [www.wmwmeyer.com](http://www.wmwmeyer.com)

File # 292-T-001

## SAFETY LABELS

Locate all of the safety labels on your equipment and know their meaning before operating your Insulation Blowing Machine.

# WARNING



**Machine is operated by remote control and can start at any time.  
Moving parts can crush and cut.**

**Follow Machine Safety Shutdown Instructions** (near control panel) before removing guards, servicing, or performing maintenance or when reaching into any work zone to make adjustments, clear product and supplies, clean the equipment, or investigate a malfunction.



**Follow all safety instructions** to reduce the risk of serious injury or death from electrical shock, moving parts, thrown objects, or other hazards.



### Intended use and use environment

This machine is suitable for Loose Fill insulation only. Any other use could cause serious injury, costly damage to the equipment and will void the warranty.

Operate only in well ventilated areas. Failure to do so could result in death due to carbon monoxide poisoning.

Questions regarding safety, operation, and application suitability should be directed to Wm. W. Meyer and Sons, Inc.



### Qualifications and responsibilities

Always refer to applicable safety standards and local requirements when using this equipment.

#### Owner responsibilities:

- Provide operation and maintenance personnel with the Installation, Operation, and Maintenance Instructions (additional copies available from Wm. W. Meyer and Sons, Inc.)
- Make sure personnel are properly trained on equipment use and safety.



#### Operation and Maintenance Personnel responsibilities:

- Be properly qualified to operate or service the equipment:
  - Read and follow all instructions on the equipment labels and in the Installation, Operation, and Maintenance Instructions, including appropriate supporting vendor information.
  - Never operate or maintain this equipment under the influence of alcohol or drugs or conditions which reduce alertness or judgment.
- Always wear proper hearing, eye and breathing protection along with protective clothing.



### Operating location

- An operator must always be close enough to the machine to promptly turn it off in case of emergency.
- Never blow insulation on or near sources of heat, flame, sparks or static discharge.



### Keep yourself and others clear of machine and discharge

- Never operate the machine without all guards properly installed.
- Keep hands, feet, hair, loose clothing, jewelry and any foreign objects away from moving parts during operation.
- Never allow untrained personnel in the area near the equipment or the air/material discharge location.
- Never direct discharged materials at bystanders or put hands or objects in the discharge stream.



DO NOT REMOVE or disfigure this or any other instruction/safety label.

1700 Franklin Blvd • Libertyville, Illinois 60048-4407 • 800-797-8227 • 847-918-0111 • Fax: 847-918-8183  
e-mail: [info@wmmeyer.com](mailto:info@wmmeyer.com) • websites: <http://www.meyercontractor.com> or [www.wmmeyer.com](http://www.wmmeyer.com)

420Z-262



## WARNING

Hydraulic fluid is flammable. Keep away from heat and ignition sources.

Clean up any spills using only non-sparking tools and explosion proof equipment. Collect spills on absorbent material and put into an approved container.

420Z-301



## WARNING

Hydraulic fluid under pressure can cause skin injection injury.

If you suspect an injury, no matter how minor it may seem, get medical attention immediately.

Failure to do so can lead to gangrene and loss of limb.

Follow Machine Safety Shutdown Instructions before any inspections, service or maintenance is performed.

420Z-302



## HYDRAULIC SYSTEM INSPECTION INSTRUCTIONS

With the truck securely parked and the machine unable to start, inspect the hydraulic system both on the machine and underneath the truck for:

- Leaks
- Loose connections
- Damaged/Worn parts

Replace any damaged or worn parts immediately. Do not operate the machine until after necessary repairs have been made.

If there are any questions about inspecting the hydraulic system, please do not hesitate to contact us at 1-800-963-4458

420Z-300



**! WARNING**

**Hot surface.  
Do NOT touch.**

420Z-233

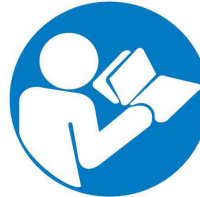

**! WARNING**

**To reduce the risk of serious injury or death:**

Equipment must be operated, serviced and maintained by trained personnel.

Read and understand all instructions before operating, servicing or maintaining this machine.



**! WARNING**

**Moving parts can crush and cut.**

Never operate with guard removed.

**Follow machine safety shutdown instructions** before service or maintenance.

420Z-253



**! WARNING**

**Unprotected material discharge can cause injury.**

Always use hose when discharging material.

Never direct discharged materials at bystanders or put hands or objects in the discharge stream.

420Z-217



Hearing protection required



Eye protection required



Breathing protection required



Protective clothing required

420Z-204

**! WARNING**

**! WARNING**



**FIRE Hazard**

Disconnect fuel tank when not in use.  
Secure tank when transporting machine.  
Do not store fuel tank in enclosed space.

420Z-289



**! DANGER**

**Rotating parts inside.**

**Follow machine safety shutdown instructions** before service or maintenance.

420Z-249



**! WARNING**

**Open all doors on the truck body/trailer and wait 10 minutes before starting engine.**

This ventilates fuel vapors and reduces the risk of fire and explosions.

**DO NOT** start engine if fuel vapors are present.

420Z-288



**! DANGER**

Engines produce **carbon monoxide** which is an odorless deadly poison. **DO NOT OPERATE** in an enclosed area.

420Z-234



**! WARNING**

**Do not reach into hopper.**

Moving parts can crush and cut.

**Follow machine safety shutdown instructions** before service or maintenance.

420Z-260

NOTE: Contact Wm. W. Meyer & Sons, Inc. at 800-963-4458 for free replacement safety label kit.

# SERIES 1500 INSULATION BLOWING MACHINE

## SAFETY PRECAUTIONS

Model 1505A

### MACHINE SAFETY SHUTDOWN INSTRUCTIONS

Before reaching into the machine or performing any service or maintenance, the following steps must be taken to ensure that the machine cannot be started or operated.

1. Follow the Machine Shutdown Instructions.
2. Disconnect the fuel tank and close the vent on the tank.
3. Disconnect the negative battery terminal and secure it.
4. Follow your employer's Lockout/Tagout procedures.

420Z-258

Model 1502

### MACHINE SAFETY SHUTDOWN INSTRUCTIONS

Before reaching into the machine or performing any service or maintenance, the following steps must be taken to ensure that the machine cannot be started or operated.

1. Follow the Machine Shutdown Instructions.
2. Disconnect the negative battery terminal and secure it.
3. Follow your employer's Lockout/Tag out procedures.

420Z-305



**NEVER OPERATE THE MACHINE WITHOUT GUARDS IN PLACE**

**NEVER OPERATE THE MACHINE WITHOUT HOSE ATTACHED TO THE DISCHARGE TUBE**